

Find Arno and his interesting facts by following this map. . .

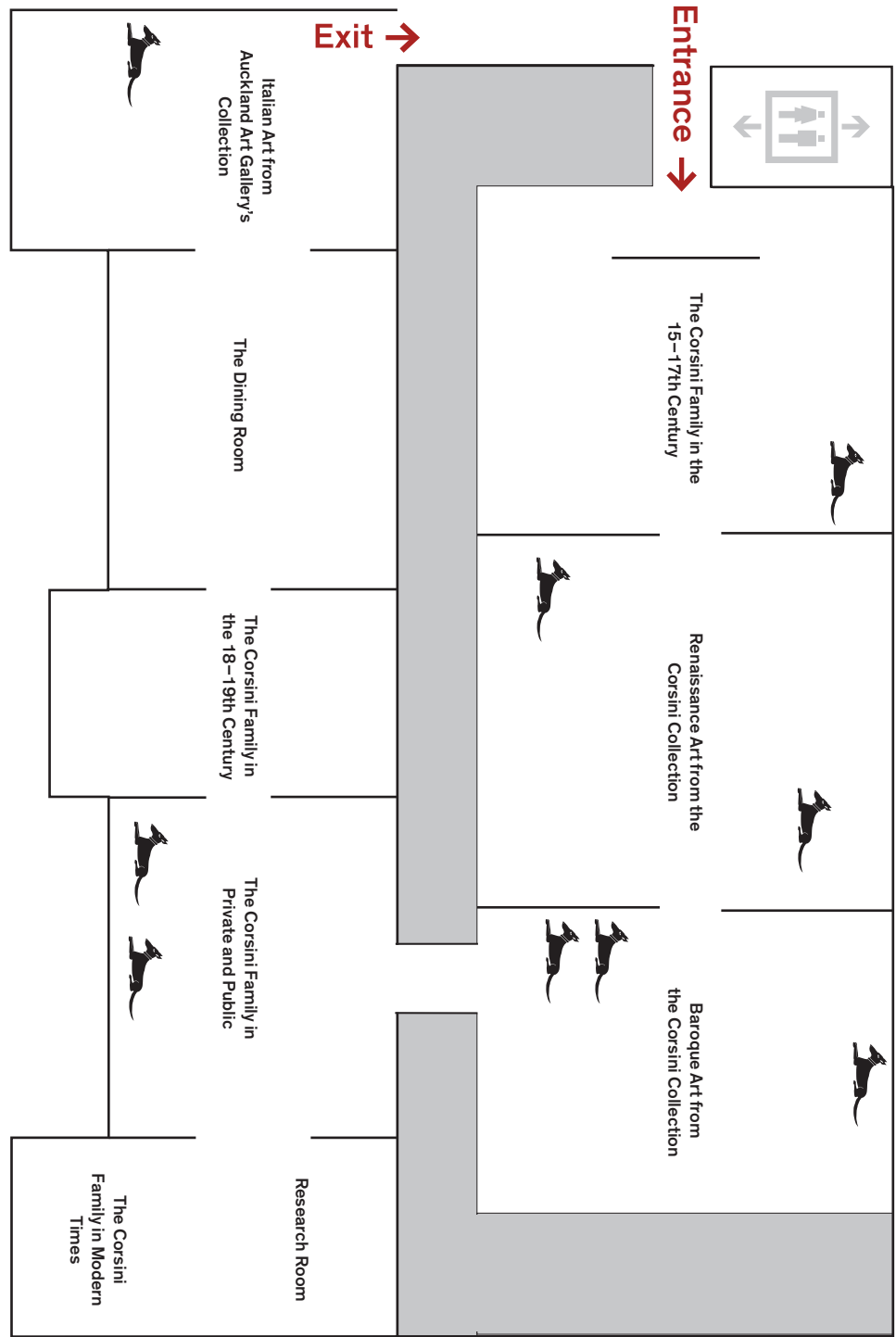

Exhibition organised by the Galleria Corsini, Florence; Auckland Art Gallery Toi o Tamaki; Art Gallery of Western Australia, Perth; and MondoMostra, Rome.

# THE COR SINI

## COLLECTION FAMILY TRAIL

Hi! I'm Arno, I will be your guide. I am one of the many dogs that the Corsini family have owned.

Look out for me in the exhibition, where I will point out interesting things.

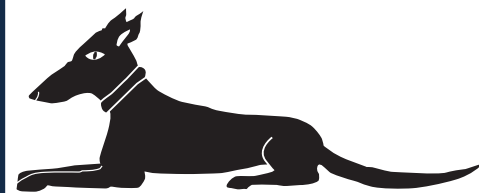

This exhibition tells a story about the Corsini family. They live in Florence, Italy, which is over 18,000 kilometres from New Zealand. The Corsini family is very important and they live in big palaces, filled with paintings and sculptures.

We often take photographs of our whānau or family. These are family portraits. Hundreds of years ago people also had family portraits – often as paintings or sculptures – made by famous artists.

In this exhibition you will see portraits and read stories about people from the Corsini family. You can trace the Corsini family history through the family tree and learn how they have lived over the last 600 years.

**AUCKLAND**  
**ART GALLERY**  
**TOI O TĀMAKI**

The Corsini family palace in Florence is filled with beautiful taonga or treasures. Look closely at the pictures below, can you find these taonga in the paintings in the exhibition?



Looking at all the artworks in the exhibition, what do you think was important or precious to the Corsini family? Imagine a portrait of yourself. What taonga or treasures would you include that tell us about you?

This is the Corsini family emblem. It is a symbol which identifies them.

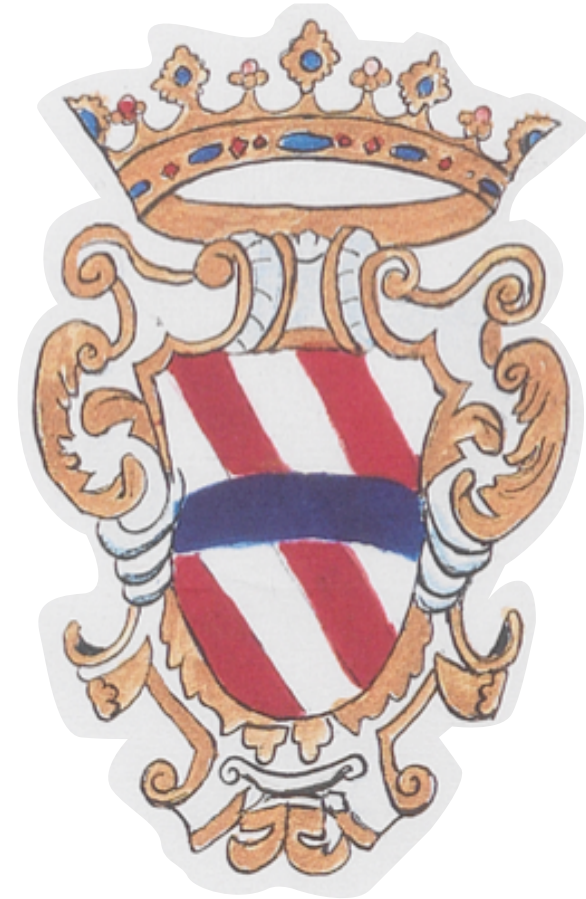

Can you find this emblem hidden in some of the artworks in this exhibition? How many times can you spot it?

Do you have a whānau or family emblem, symbol or pattern with which you identify? Or, if you could design your family emblem, what colours, symbols and patterns would you choose? Why?